

# Prestige Gold Coast

极致奢华的生活



**COPYRIGHT**  
 T.J.V. DESIGN. This work is covered by copyright and cannot be reproduced or stored in any form or by any means, electronic, mechanical, photocopying, recording, or otherwise, without the prior written permission of T.J.V. DESIGN. All rights reserved. For more information, please contact T.J.V. DESIGN, 18/08/2012, 081010, SK-12/a.

WATER FRONT

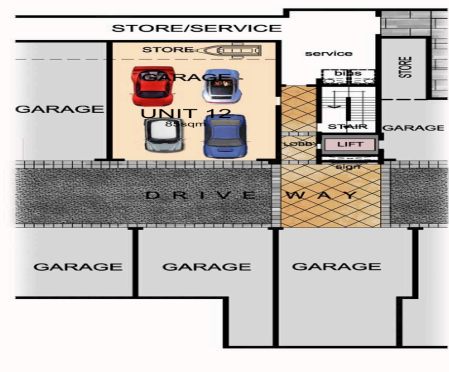

STREET FRONT

**UNIT 12.**  
 enclosed areas: 310sqm  
 balconies: 68sqm  
 roof garden: 188sqm  
 garage: 85sqm  
**TOTAL: 649sqm**

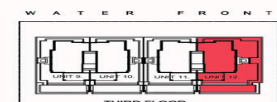
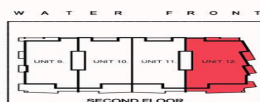

**KEY PLANS**



**T.J.V. DESIGN**  
 Level 3, Pacific Administration Plaza, 233 Spring Street,  
 Northbridge, Queensland, 4215,  
 AUSTRALIA  
 Ph: 07 5571 2825 Fax: 07 5571 2826  
 Email: tjv@tjvdesign.com.au  
 Postbox 8470, G.C. N.S.W., Bundabell Queensland 4217  
 www.tjvdesign.com.au

20-24 Oatland Es. Runaway Bay, Gold Coast, Australia  
 UNIT 12 - PLANS

18 AUGUST 2012  
 081010 SK-12/a  
 SCALE 1 : 200